

- Status
- PLANNING
1.

2.

3.

4.

Do not scale off this drawing.

All Bell Phillips architects drawings to be read in conjunction with written specification and all other consultant drawings.

All dimensions to be checked on site.

Any errors or omissions to be reported to Bell Phillips architects immediately, prior to work being carried out.

- Key
1. Extensive green roof.

2. Metal coping (PPC or anodised finish).

3. Glazed rooflight.

4. Photovoltaic panel (indicative layout).

5. Timber/aluminium composite glazed windows/balcony doors (PPC or anodised finish)

6. Metal framed glazed door and side panel to entrances (PPC or anodised finish).

7. Solid timber doors to plant/refuse (factory finished).

8. Solid timber doors (factory finished) with double glazed side panel.

9. Facing brickwork.

10. External lighting.

11. Metal fascia to balcony edge (PPC or anodised finish).

12. Metal balustrade (PPC or anodised finish).

13. Fabricated metal fence comprising vertical railings (PPC or anodised finish).

14. Sawtooth course detail in brickwork.

15. Hit and miss brickwork for ventilation.

16. Recessed metal rain water pipe (PPC or anodised finish).

17. Timber/aluminium composite translucent glazed windows/balcony doors (PPC or anodised finish).

No.	Revisions	Date
-----	-----------	------

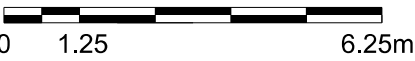

BELL PHILLIPS ARCHITECTS

First Floor

43 Tanner Street

London SE1 3PL

T

E

W

020 7234 9330

info@bellphillips.com

www.bellphillips.com

Copyright:

This drawing is the property of Bell Phillips architects. No disclosure or copy of it may be made without the written permission of Bell Phillips architects

Project

KIPLING ESTATE GARAGES

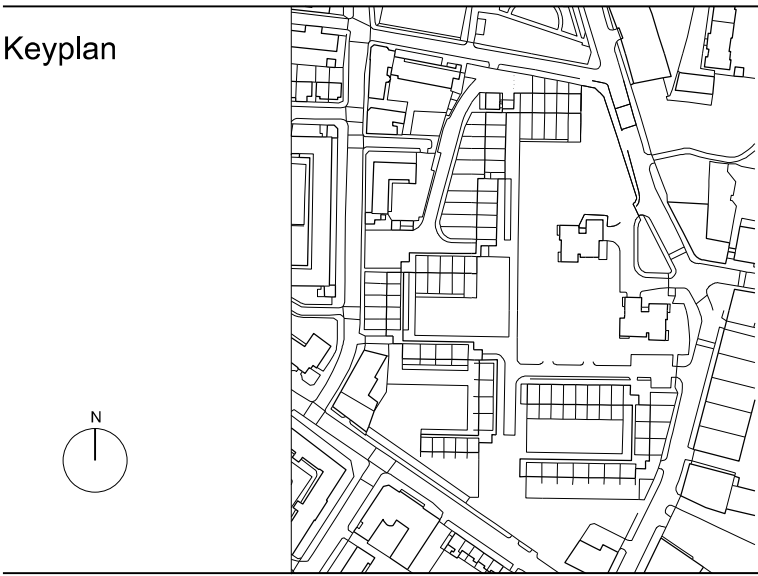

Title

PROPOSED SECTION CC'

Job	Drawing No.		Rev.
0336	P 2202		-
Drawn	Scales at A1	Scales at A3	Date
HP	1:125	1:250	06/15